

- Notes:**
- Do not scale from this drawing.
 - All dimensions are in meters unless otherwise stated.
 - This drawing is to be read with all other relevant drawings and reports.
 - All works to be in accordance with the Specification for Highway Works.
 - These drawings supplement 4.04.00 PK1002-RAM-HDG-MLE-SG-DZ-0001 Drainage Strategy Report.
 - For planting and amenity arrangements, refer to 2.08.00 Drainage Layout Plans PK1002-RAM-HDG-MLE-DR-DZ-0503 to 0512.
 - For drainage details, refer to 2.08.04 Drainage Typical Details PK1002-RAM-HDG-MLE-DE-DZ-0001 to 0006.
 - Please refer to 3.03.00 Environmental Statement Chapter 3: Description of Scheme for the Rochdale Envelope flexibility included within the design for the purposes of Environmental Impact Assessment.
 - This drawing is for planning application purposes only, it is not a construction issue drawing.

- Key:**
- Red Line Boundary
 - Flood Exceedance Extents
 - Flood Exceedance Route
 - Proposed Drainage Basin
 - Surface Water Manhole (HCD F3-F6)
 - Catchpit (HCD F11)
 - Proposed Gully (HCD F13)
 - Proposed Combined Kerb Drainage Outlet/Access Point
 - Inline Outlet to Trapezoidal Surface Water Channel (HCD F23)
 - Inline Outlet to Triangular Surface Water Channel (HCD F22) (1/2/3 Chambers Depending on Requirements)
 - Catchpit (HCD F12)
 - Surface Water Carrier Drain
 - Proposed Combined Filter/Carrier Drain (HCD F2, Type H)
 - Proposed 100mm Dia Narrow Filter Drain (HCD F18)
 - Proposed Gully Lead
 - Concrete Surface Water Channel (HCD B14, type A)
 - Grip Overflow
 - Grassed Swale (Lined)
 - Viaduct Carrier Drain
 - Proposed Pre Earthworks Ditch (PED)
 - Highways Ditch
 - Proposed Culvert/Piped Ditch
 - Inlet/Outlet Headwall (Refer to Headwall 2 Option 1 or 2)

Mapping reproduced by permission of Ordnance Survey on behalf of HMSO.
 © Crown copyright and database rights 2024 Ordnance Survey 100019340.

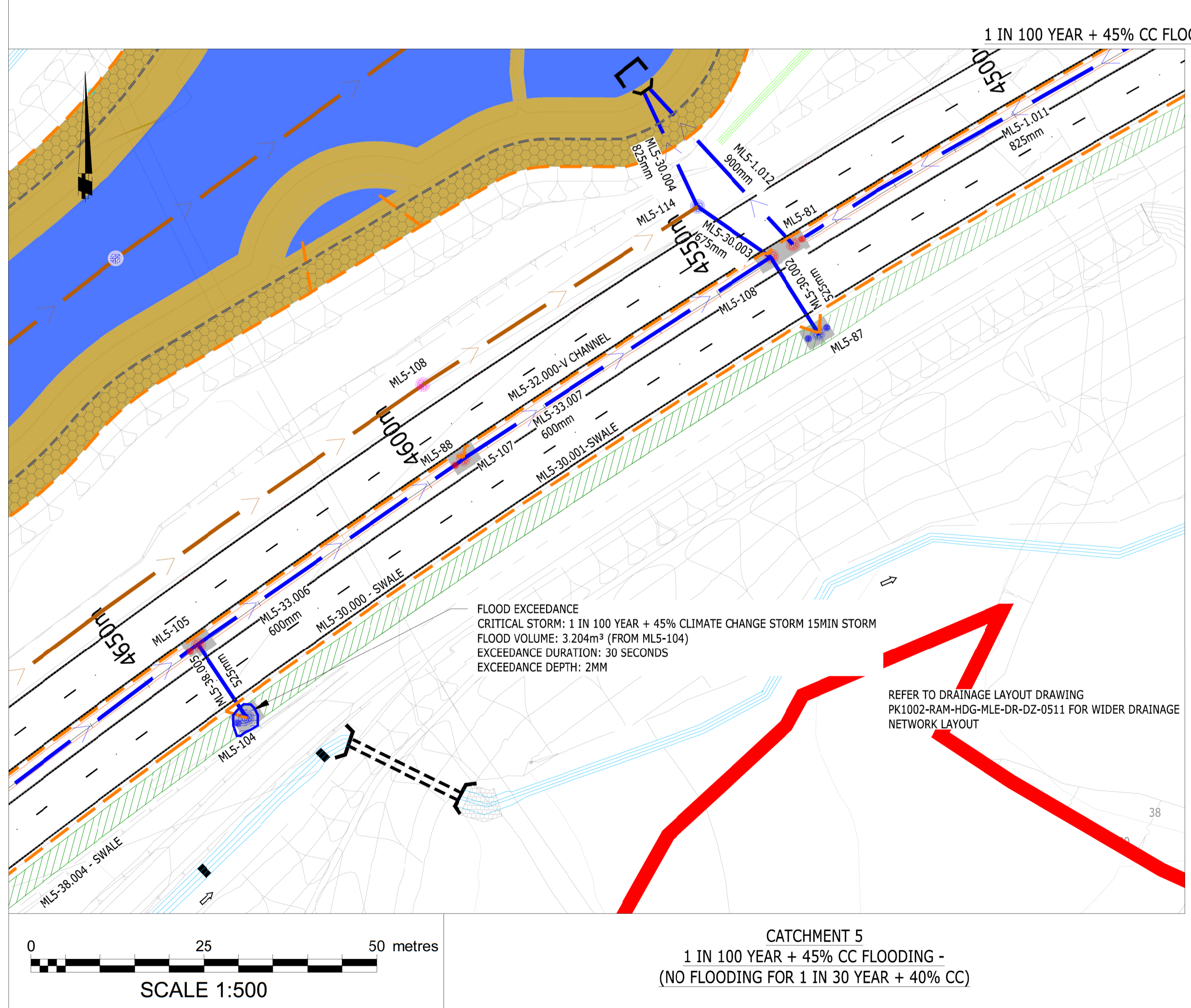

A1 - Authorised for Planning

REVISION	DRAWN	CHECKED	APPROVED	DATE
C01	GSK	KJ	SS	08/02/24

CLIENT

Norfolk County Council
 Grahame Bygrave
 Interim Executive Director of
 Community and Environmental Services
 Norfolk County Council
 County Hall, Martineau Lane
 Norwich NR1 2SG

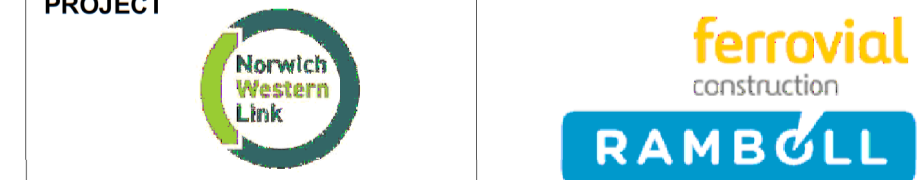

DRAWING TITLE

NORWICH WESTERN LINK
 EXCEEDANCE FLOW PLAN
 SHEET 2 OF 2

DRAWING STATUS
 A1 - AUTHORISED FOR PLANNING

DRAWN	CHECKED	APPROVED	AUTHORISED
GSK	KJ	SS	FQC

SCALE @ A1 SIZE	DATE	REVISION
AS SHOWN	08/02/24	C01

DRAWING NUMBER

PK1002-RAM-HDG-MLE-DR-DZ-0561